

CITY OF MELTON
ENGINEERING PLANS
(LANDSCAPE)
APPROVED
 06 Apr 2023
 CITY DESIGN DATE

LEGEND

- PROPOSED TREES
Refer Plant Schedule, Specification & Details 01/L02 & 02/L02.
- GARDEN BED PLANTING
Refer Plant Schedule, Specification & Planting Plans & Detail 03/L03
- GRASSING
Refer Specification
- GRASSING - INSTANT TURF
Refer Specification and Detail 03/L02
- MULCH ONLY GARDEN BEDS
Refer Specification
- SPADE EDGING
Refer Detail 04/L03 and Specification
- FENCING F1 - BOLLARD & CABLE FENCE
Refer Detail 05/L03 and Specification
- FENCING F2 - TIMBER PALING FENCE
By Civil
- STAGE BOUNDARY

CULTIVATION NOTE

Cultivation to be approved by the Superintendent prior to Civil placing topsoil.

DRAWING ACCURACY

This drawing has been prepared upon Engineering drawings which may have been superseded. The Contractor is advised to consult with other trades and the Construction Manager should any discrepancies become apparent prior to & during construction.

SERVICES NOTES

Location of all services are to be confirmed on site. Contact 'Dial Before You Dig' & Refer Civil drawings for services key and further detail.

SETOUT NOTE

Setout to be approved on site by the Superintendent prior to commencement of construction works.

TREE SETOUT GUIDELINES

1. Street trees are to be positioned on site generally in accordance with the following offsets, where possible:
 - Pedestrian pathways 1.2m
 - Driveways 2.5m
 - Side entry pits or standard pits 2m
 - Service crossings 2m
 - Fire plugs 3m
 - Domestic service tapping points 2m
 - Stormwater outlet points 2m
 - Intersections 10m (or following splay of the Lot)
- Electrical infrastructure
Light poles 2.5m
2. Proposed trees may require removal / relocation to allow for services, crossovers and lighting.
3. Nature strip trees are to be located mid-way between front of path and back of kerb (except where indicated otherwise on the drawing). Where a footpath is not provided, trees are to be placed as though a footpath existed.
4. Trees are not to be placed directly above services.
5. Final setout of trees to be confirmed on site by the Superintendent & Council prior to installation.

PLANT SCHEDULE (STAGE 7 STREETScape)

SYMBOL	BOTANICAL NAME	COMMON NAME	MATURE HEIGHT & SPREAD (m)	INSTALLED POT SIZE	INSTALLED HEIGHT (min)	QUANTITY
STREET TREES						
Fp	<i>Fraxinus pennsylvanica</i> 'Urbdeli'-Urbanite'	Urbanite Ash	11.0 x 8.0m	45L / 30mm cal.	2.0m	36
Cc	<i>Corymbia citriodora</i>	Lemon Scented Gum	25.0 x 12.0m	45L / 30mm cal.	2.0m	23
Ma	<i>Melia azedarach</i> 'Caroline'	Low fruiting White Cedar	10.0 x 8.0m	45L / 30mm cal.	2.0m	7
Up	<i>Ulmus parvifolia</i> 'Todd'	Chinese Elm	10.0 x 9.0m	45L / 30mm cal.	2.0m	12
STREET TREES (SPIDER FLOWER LANE)						
LI	<i>Lomandra</i> 'Lime Tuff'	Mat Rush	0.5-0.6 x 0.5-0.6m	140mm	-	239

KEY REVISIONS:

REV A Updated tree locations & quantities in schedule
 REV B Updated tree locations lots 761-775 & quantities in schedule
 REV C Updated tree locations lots 761-775 & quantities in schedule
 REV D Updated tree locations lots 742,743, 768, 769 & quantities in schedule

FOR TOWN PLANNING
NOT FOR CONSTRUCTION

Rev	Date	Description
D	22.03.2023	Revised Council Issue
C	15.11.2022	Revised Council Issue
B	28.10.2022	Revised Council Issue
A	04.10.2022	Revised Council Issue
-	18.08.2022	Council Issue

451 BEATYS DEVELOPMENT PTY LTD

BOTANIA RESIDENTIAL SUBDIVISION
 1152-1174 TAYLORS ROAD & 451-471 BEATYS ROAD, PLUMPTON

STAGE 7 LANDSCAPE STREETScape PLAN

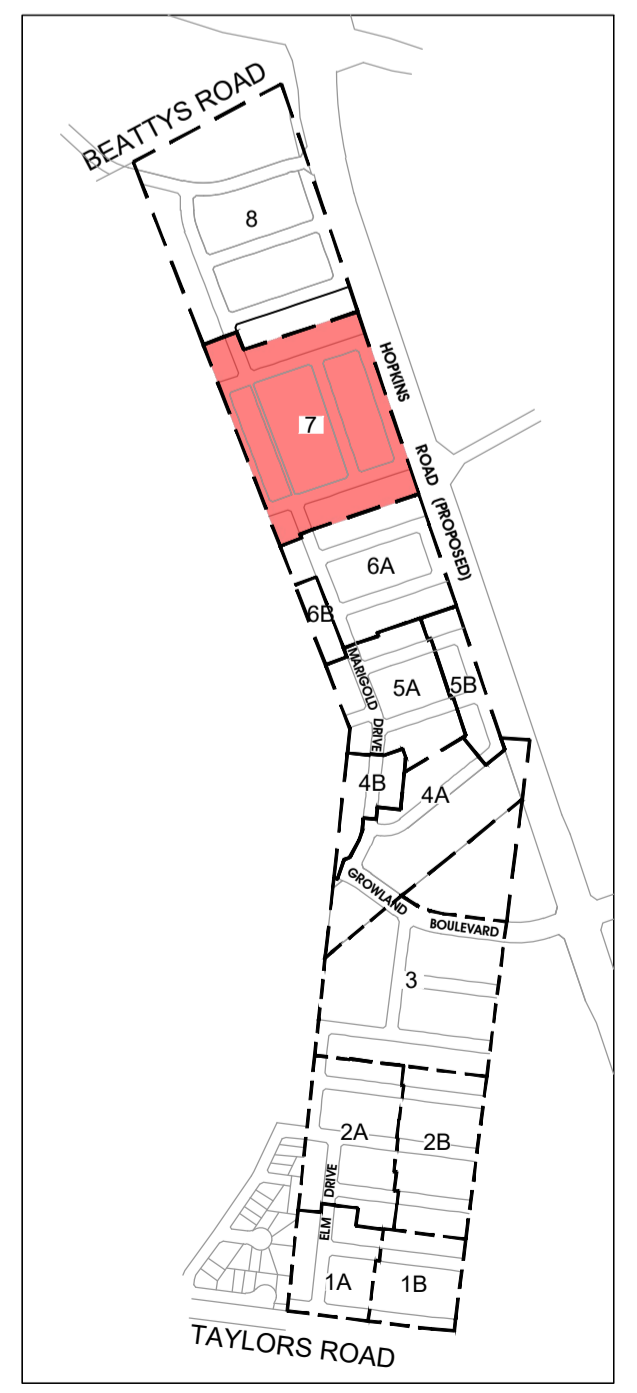
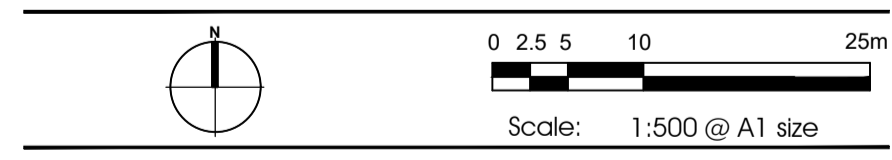

CDA Design Group Pty Ltd
 Landscape Architecture
 Urban Design
 185 Faraday Street
 Carlton Victoria 3053
 T 03 9349 5866
 F 03 9349 5877
 E office@cdaesigngroup.com.au

Project No. 19029_7
 Date: JUNE 2022
 Drawn by: ET
 Checked: TV

Drawing No. L01D

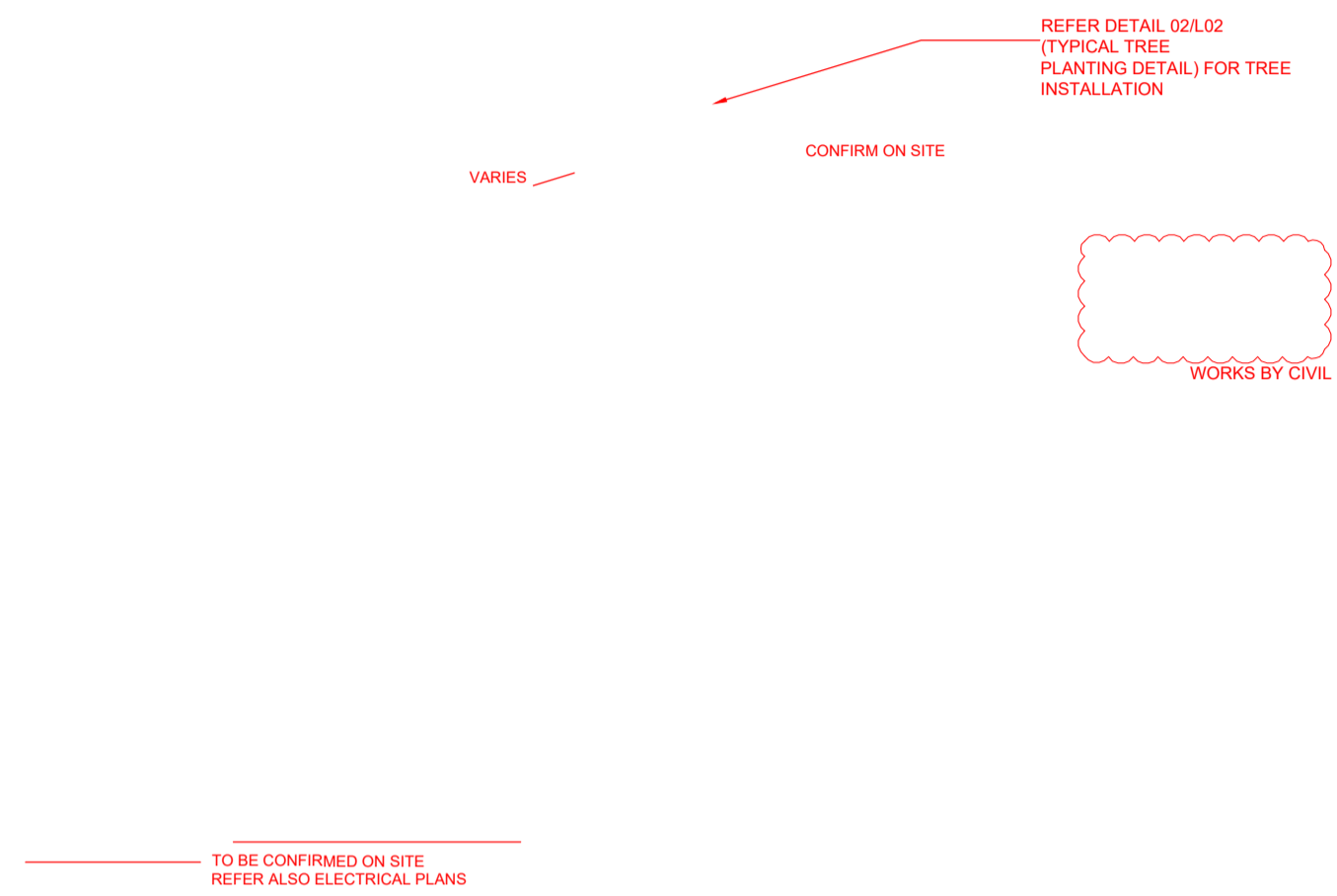

01 COUNCIL STANDARD PASSIVE STREET TREE IRRIGATION GRAVEL TRENCH DETAIL (BY LANDSCAPE)
Scale: NTS

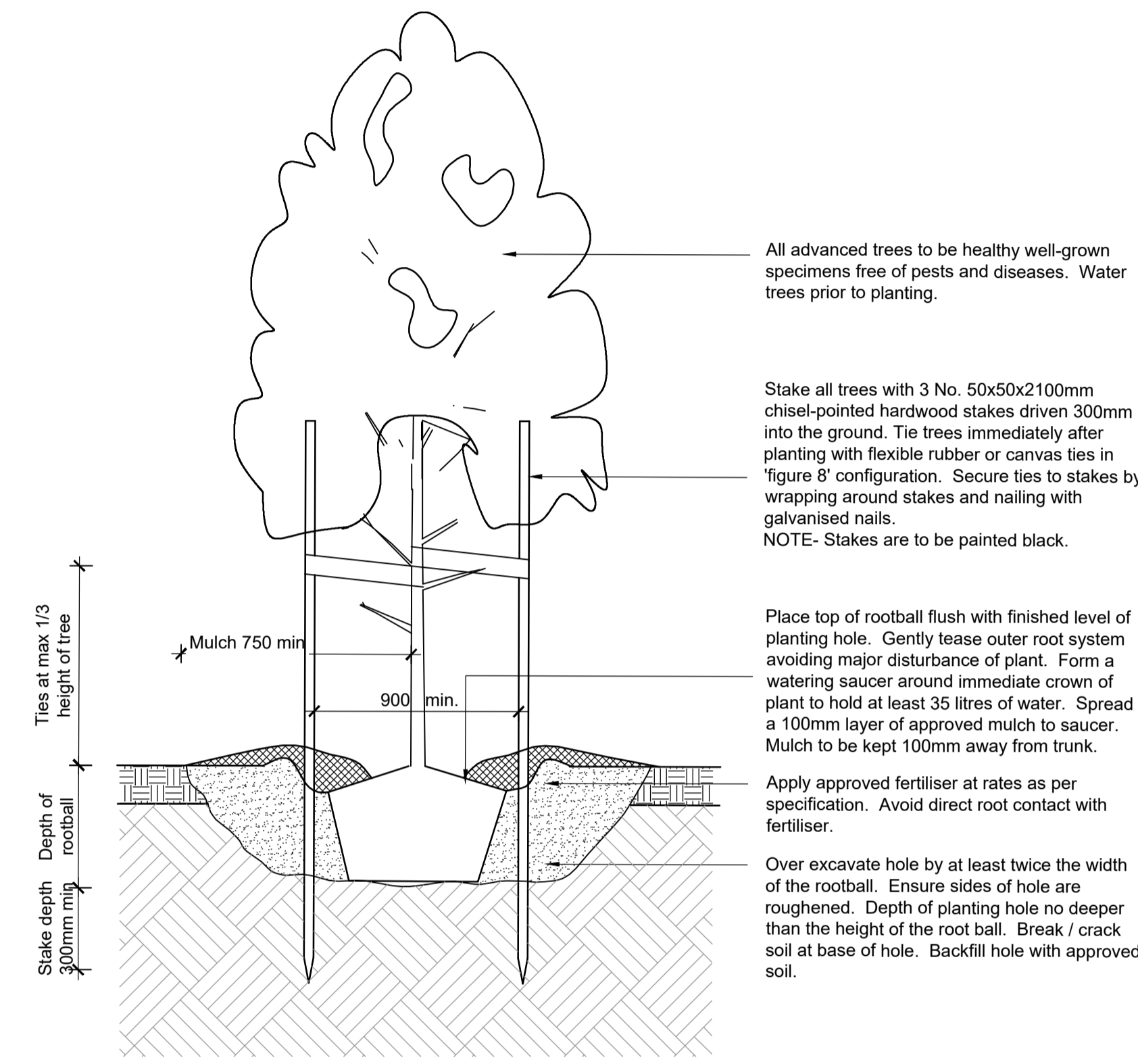

02 TYPICAL TREE PLANTING DETAIL
Scale: 1:20 @ A1

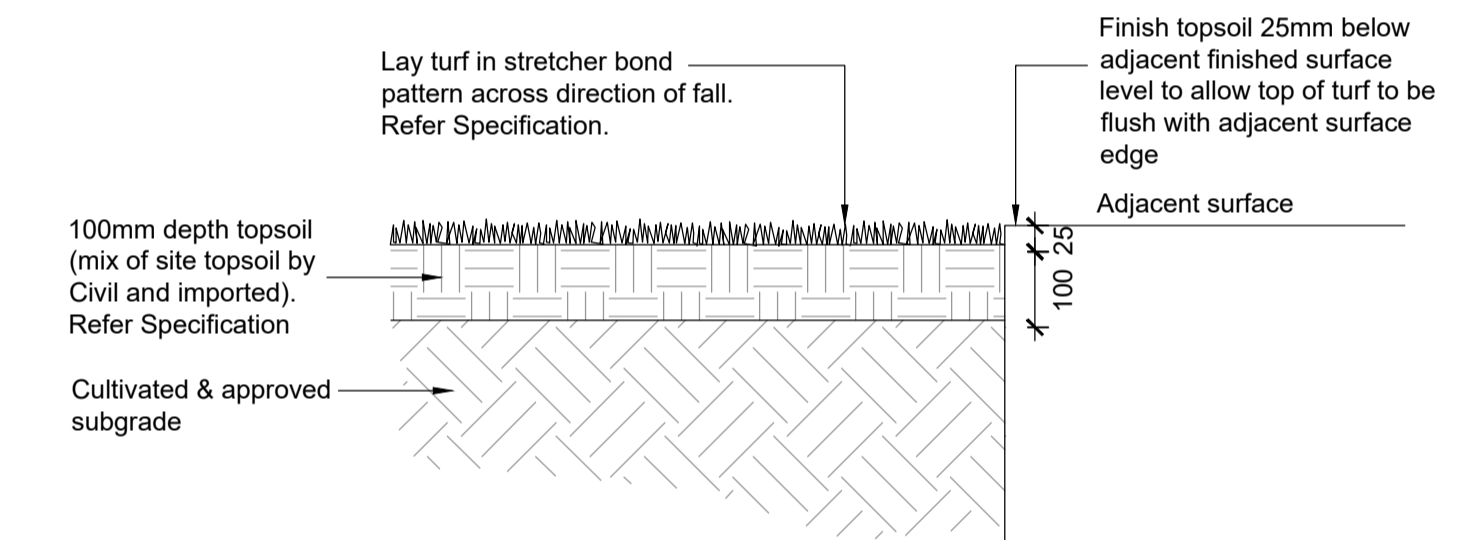

03 TYPICAL TURF DETAIL
Scale: 1:10 @ A1

**FOR TOWN PLANNING
NOT FOR CONSTRUCTION**

Rev	Date	Description
-	22.03.2023	Council Issue (reissue)
-	15.11.2022	Council Issue (reissue)

451 BEATYS DEVELOPMENT PTY LTD

BOTANIA RESIDENTIAL SUBDIVISION
1152-1174 TAYLORS ROAD & 451-471 BEATTYS ROAD, PLUMPTON

**STAGE 7 STREETScape
LANDSCAPE DETAILS**

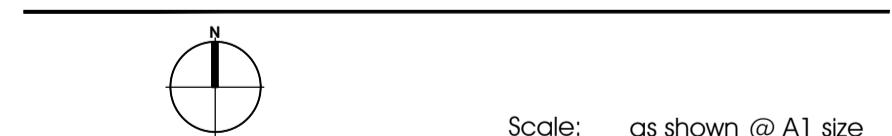

CDA Design Group Pty Ltd
Landscape Architecture
Urban Design
185 Faraday Street
Carlton Victoria 3053
T 03 9349 5866
F 03 9349 5877
E office@cdaesigngroup.com.au

Project No. 19029_7
Date: JUNE 2022
Drawn by: KH
Checked: TV
Drawing No. L02

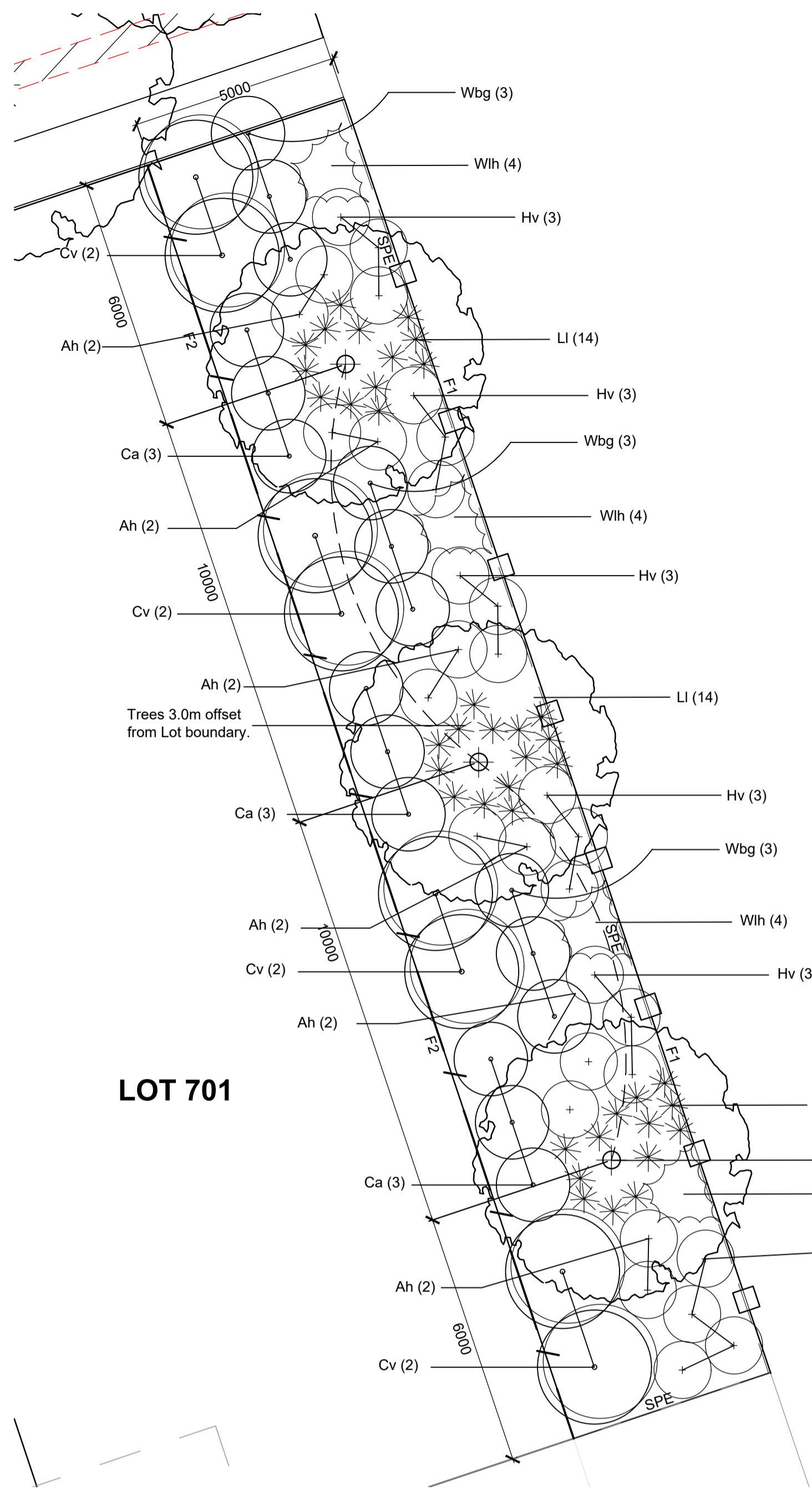

01 LOT 701 TREE RESERVE PLANTING PLAN
Scale: 1:100 @ A1

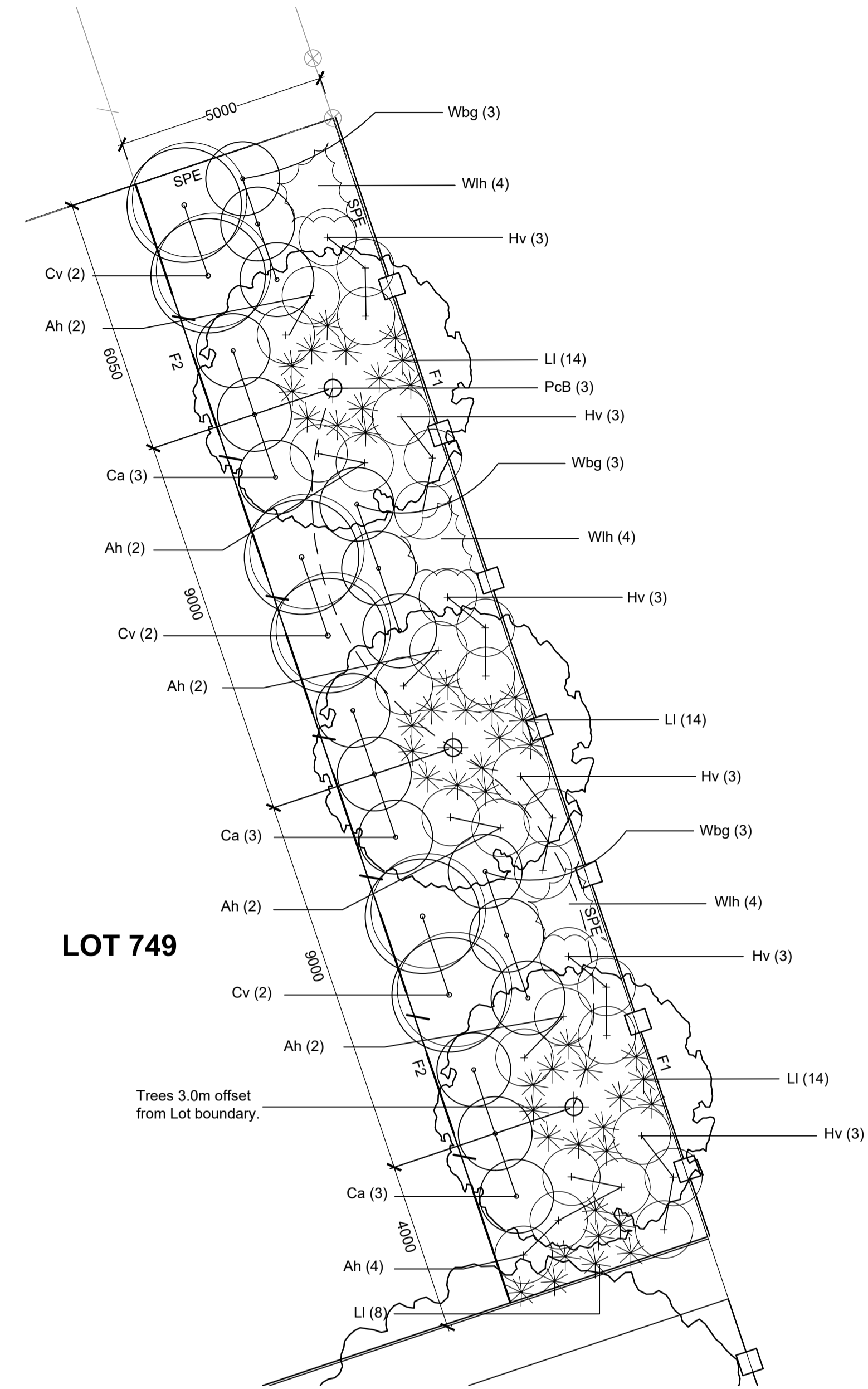

02 LOT 749 TREE RESERVE PLANTING PLAN
Scale: 1:100 @ A1

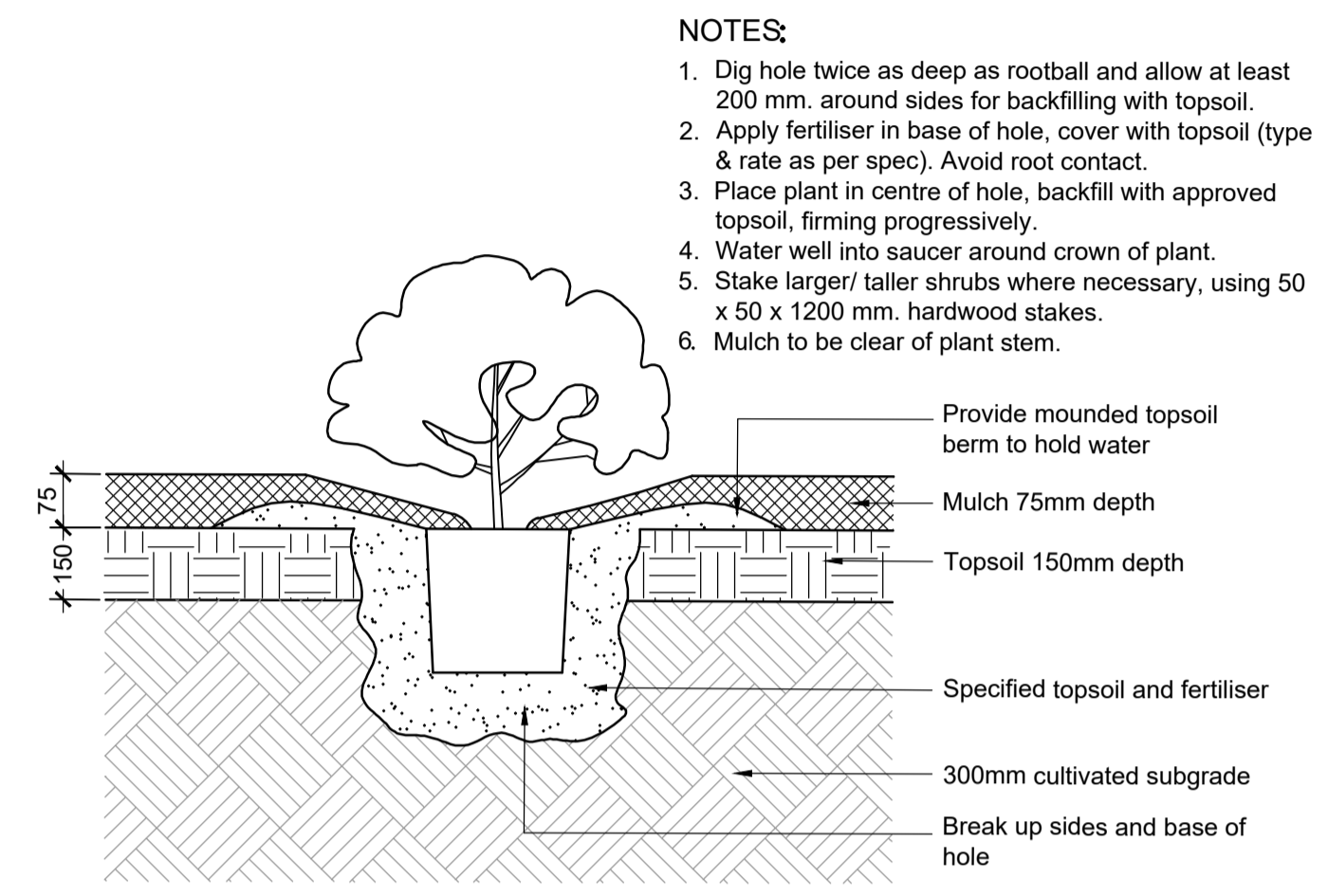

03 TYPICAL SHRUB PLANTING DETAIL
Scale: 1:10 @ A1

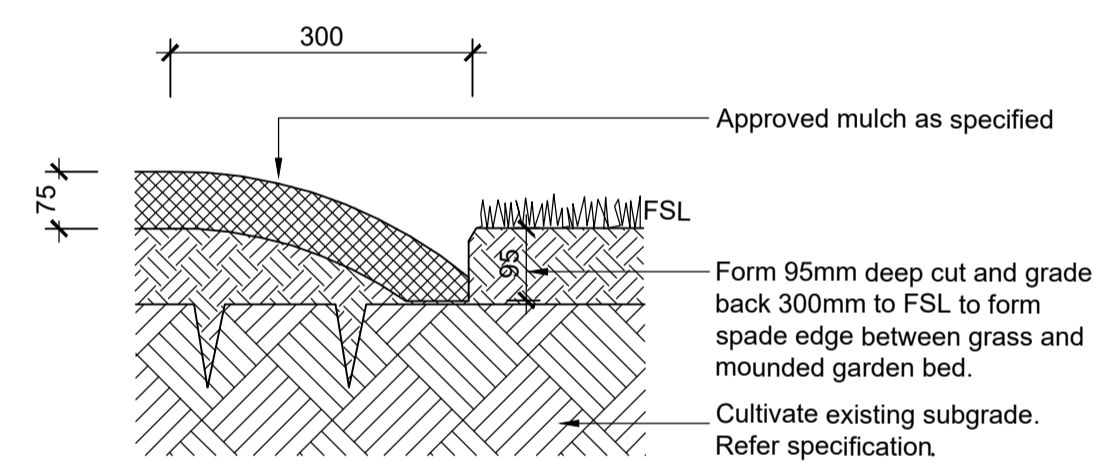

04 TYPICAL SPADE EDGE DETAIL
Scale: 1:10 @ A1

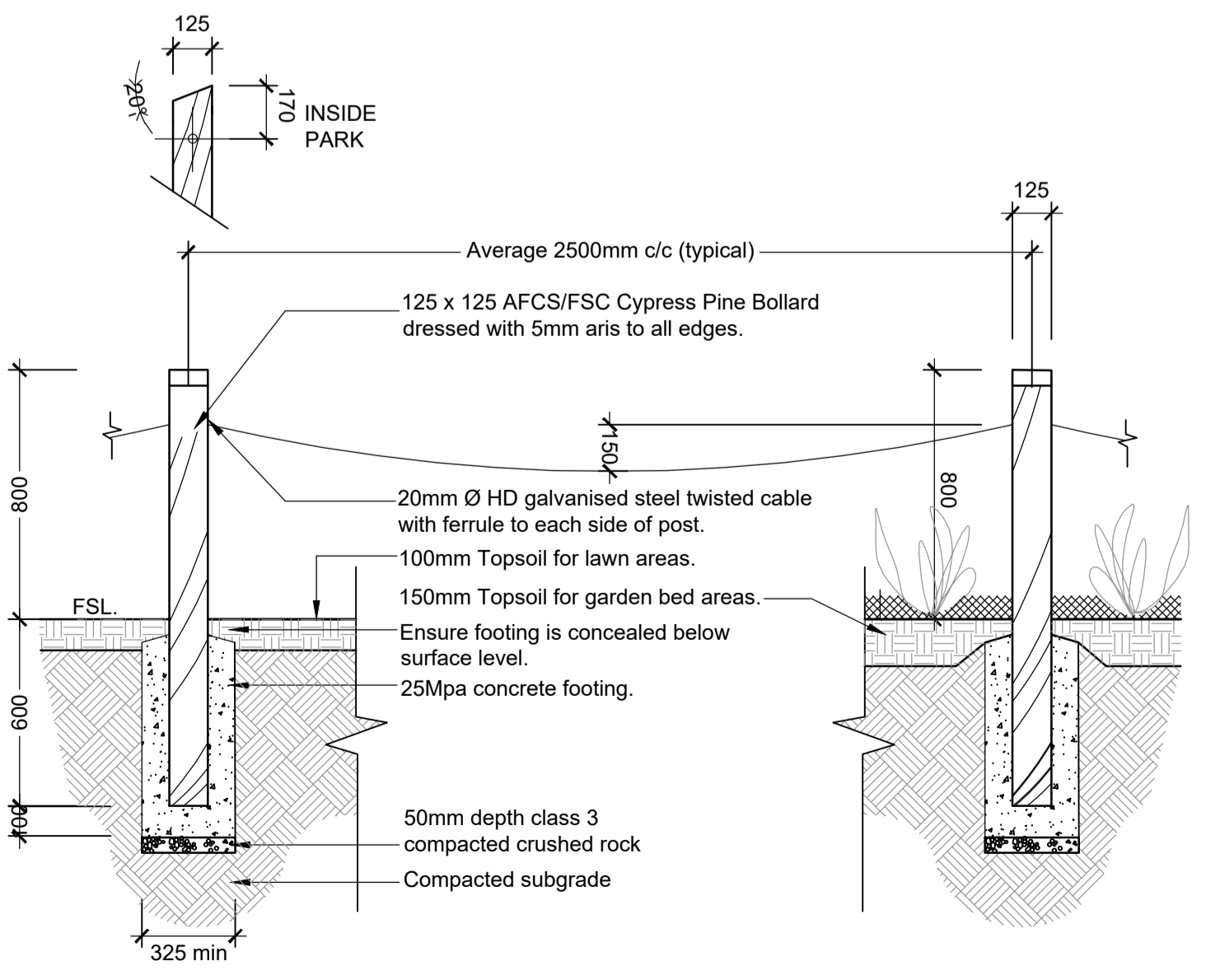

05 BOLLARD & CABLE FENCE DETAIL
Scale: 1:20 @ A1

FIXINGS:
All fixings and cables are to be hot dip galvanised to ensure corrosion resistance. All site cuts to cables shall be appropriately treated with a zinc rich, cold galvanised paint.

SETOUT & OPENINGS:
Refer landscape plan. Setout to be approved on site by the Superintendent & Council prior to installation.
Refer Melton Standard Detail MCCLA405 for variations to setout tolerances.
Typically openings at pedestrian points locations to be 1200mm and 1500mm max.
Cable span between posts 2000mm to 2500mm max.
Bollard fencing to be located 1200mm off BOK and 1000mm alongside pedestrian paths unless otherwise noted on the landscape plans.

NOTE:
Openings centered to trees along Moonflower Drive and Zelkova Circuit to be 3m (tree positioned at 1.5m)

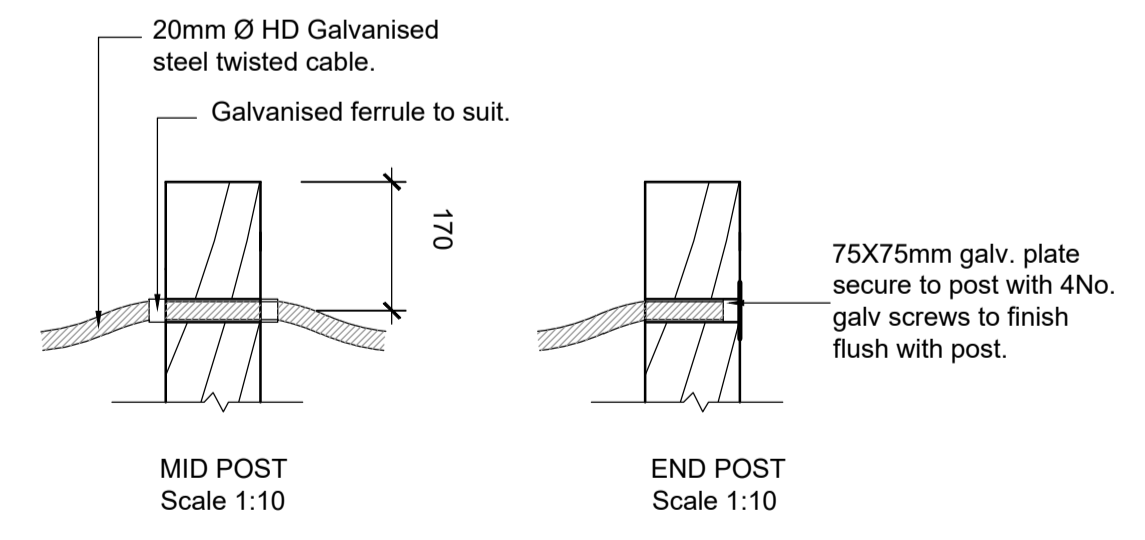

- LEGEND**
- PROPOSED TREES
Refer Plant Schedule, specification & Detail 02/L02
 - SPADE EDGING
Refer Detail 04/L03 and specification. Edging to be removed with removal of sacrificial planting
 - FENCING F1 - BOLLARD & CABLE FENCE
Refer Detail 05/L03 and specification.
 - FENCING F2 - TIMBER PALING FENCE
By Civil
 - STAGE BOUNDARY

CULTIVATION NOTE
Cultivation to be approved by the Superintendent prior to Civil placing topsoil.

DRAWING ACCURACY
This drawing has been prepared upon Engineering drawings which may have been superseded. The Contractor is advised to consult with other trades and the Construction Manager should any discrepancies become apparent prior to & during construction.

SERVICES NOTES
Location of all services are to be confirmed on site. Contact 'Dial Before You Dig' & Refer Civil drawings for services key and further detail.

SETOUT NOTE
Setout to be approved on site by the Superintendent prior to commencement of construction works.

- NOTES:**
1. Dig hole twice as deep as rootball and allow at least 200 mm. around sides for backfilling with topsoil.
 2. Apply fertiliser in base of hole, cover with topsoil (type & rate as per spec). Avoid root contact.
 3. Place plant in centre of hole, backfill with approved topsoil, firming progressively.
 4. Water well into saucer around crown of plant.
 5. Stake larger/ taller shrubs where necessary, using 50 x 50 x 1200 mm. hardwood stakes.
 6. Mulch to be clear of plant stem.

CITY OF MELTON
ENGINEERING PLANS
(LANDSCAPE)
APPROVED
06 Apr 2023
CITY DESIGN DATE

FOR TOWN PLANNING
NOT FOR CONSTRUCTION

Rev	Date	Description
-	22.03.2023	Council Issue (reissue)
-	15.11.2022	Council Issue (reissue)

451 BEATYS DEVELOPMENT PTY LTD

BOTANIA RESIDENTIAL SUBDIVISION
1152-1174 TAYLORS ROAD & 451-471 BEATTYS ROAD, PLUMPTON

STAGE 7 STREETSCAPE
TREE RESERVES PLANTING PLANS & DETAILS

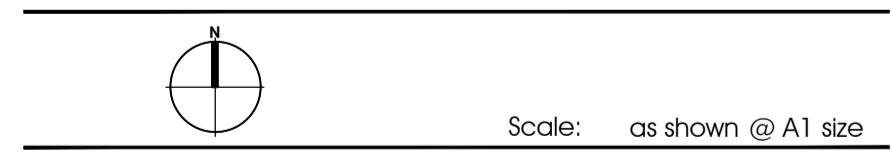

PLANT SCHEDULE (FOR TREE RESERVE)

KEY	BOTANICAL NAME	COMMON NAME	MATURE HEIGHT & SPREAD (m)	INSTALLED POT SIZE	INSTALLED HEIGHT (min)	QTY
TREES						
PcB	<i>Pyrus calleryana</i> x <i>Pyrus betulalefolia</i>	Edgedell Edgewood	6 x 4	45L/30mm cal.	2.0m	6
SHRUBS						
Ah	<i>Acacia howittii</i> 'Honey Bun'	Dwarf Sticky Wattle	1-1.2 x 1-1.2	140mm	-	26
Ca	<i>Correa alba</i>	White Correa	1-1.5 x 1-1.5	140mm	-	18
Cv	<i>Callistemon viminalis</i> 'Hannah Ray'	Weeping Bottle Brush	4 x 2	200mm	-	14
Hv	<i>Hardenbergia violacea</i> 'Meema'	Hardenbergia Meema	0.5 x 2	140mm	-	38
Wbg	<i>Westringia</i> 'Blue Gem'	Blue Gem Westringia	1-1.5 x 0.8	140mm	-	18
GROUND COVER						
Wih	<i>Westringia</i> 'Low Horizon'	Prostrate Westringia	0.3 x 0.7	140mm	-	28
TUFTING PLANTS						
LI	<i>Lomandra</i> 'Lime Tuff'	Mat Rush	0.5 x 0.5	140mm	-	77

CDA Design Group Pty Ltd
Landscape Architecture
Urban Design
185 Faraday Street
Carlton Victoria 3053
T 03 9349 5866
F 03 9349 5877
E office@cda-designgroup.com.au

Project No. 19029_7
Date: JUNE 2022
Drawn by: KH
Checked: TV
Drawing No. L03